

CAMAC 3000

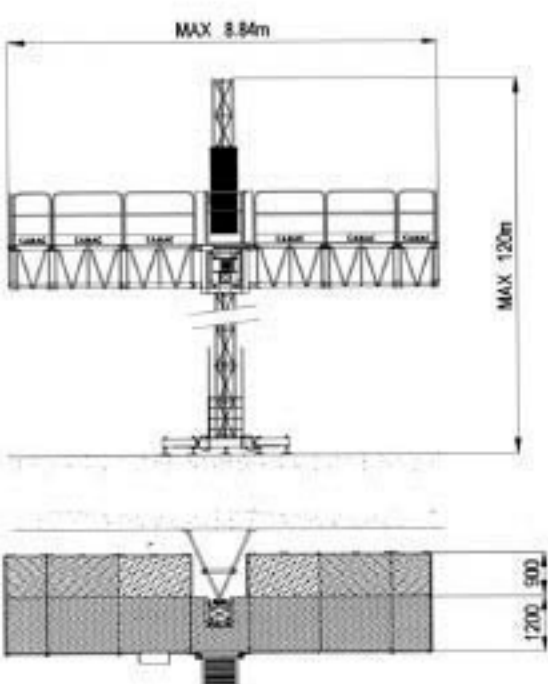

SKETCH MONOCOLUMN CAMAC-3000

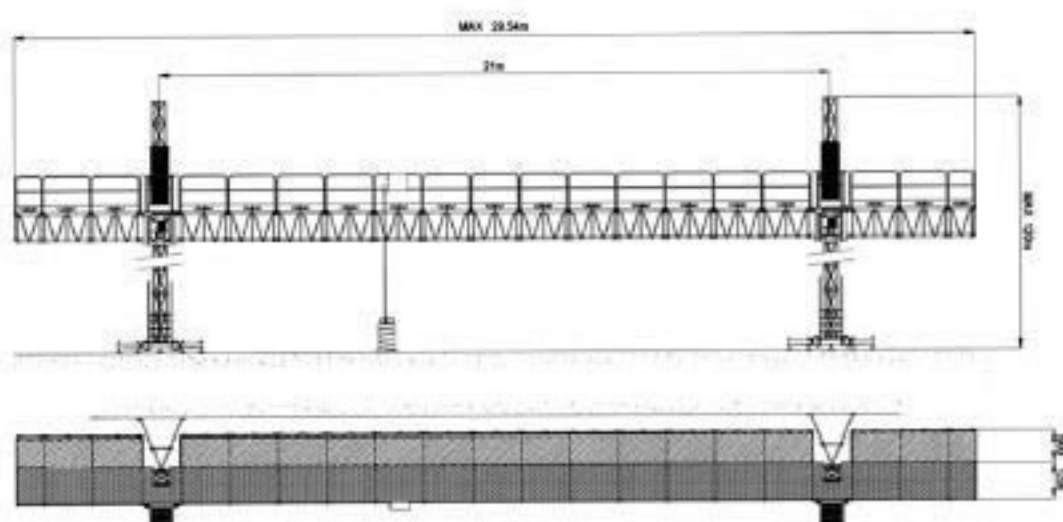

SKETCH BICOLUMN CAMAC-3000

MONOCOLUMN

CAMAC 3000

TECHNICAL SPECIFICATIONS

| | |
|----------------------|------------|
| Max. Platform Length | 10,20 m |
| Platform Width | 1,2+0,9 m. |
| Climbing Speed | 10 m/min |
| Max. Load Capacity | 1.710 Kg. |
| Maximum Height | 120 m. |
| Motor power | 4,1 Kw. |

BICOLUMN

CAMAC 3000

TECHNICAL SPECIFICATIONS

| | |
|----------------------|------------|
| Max. Platform Length | 29,54 m. |
| Platform Width | 1,2+0,9 m. |
| Climbing Speed | 10 m/min. |
| Max. Load Capacity | 3.420 Kg. |
| Maximum Height | 120 m. |
| Motor power | 4,1 Kw. |

SQUARE COLUMN COMPATIBLE WITH EC-1700/150, ECP-1500/150 AND EPM-1550/150

Remark: It's a must to place minimum 1 Anchorage every 6 m.